

Entry No. 24608
 Indexed ✓
 Abstracted ✓
 Reg. Fee

EAST CARBON CITY
 AUG 1 1 32 PM '89
 BOOK 4 PLATS
 PAGE 280
 AND SHERRIN
 COUNTY RECORDER

ENGINEER'S CERTIFICATE

I, EVAN E. HANSEN DO HEREBY CERTIFY THAT I AM A REGISTERED LAND SURVEYOR AND PROFESSIONAL ENGINEER HOLDING CERTIFICATES NO. 3115 AND NO. 3354 RESPECTIVELY, AS PRESCRIBED UNDER THE LAWS OF THE STATE OF UTAH. I FURTHER CERTIFY THAT THIS IS A TRUE AND ACCURATE MAP OF THE TRACT OF LAND TO BE ANNEXED TO EAST CARBON CITY, CARBON COUNTY, UTAH.

BOUNDARY DESCRIPTION

A PARCEL OF LAND LOCATED IN THE SOUTH HALF OF SECTION 7 AND THE SOUTH HALF OF SECTION 8 AND ALL OF THE LAND SOUTH OF STATE HIGHWAY 123 IN SECTION 9 AND ALL OF THE LAND SOUTH OF STATE HIGHWAY 123 IN THE WEST HALF OF SECTION 10 AND THE WEST HALF OF THE EAST HALF OF SECTION 10, AND THE NORTH HALF OF SECTION 17 AND THE NORTH HALF OF SECTION 18 AND ALSO ALL OF SECTION 16, ALL OF WHICH IS LOCATED IN TOWNSHIP 15 SOUTH, RANGE 13 EAST, SALT LAKE BASE AND MERIDIAN, BEING FURTHER DESCRIBED:
 COMMENCING AT THE SOUTHEAST CORNER OF THE SOUTHWEST QUARTER OF THE SOUTHEAST QUARTER OF SECTION 10, TOWNSHIP 15 SOUTH, RANGE 13 EAST, SALT LAKE BASE AND MERIDIAN; THENCE AS FOLLOWS:

COURSES	DISTANCE	REMARKS
WEST	≈3,960'	TO THE SW CORNER SECTION 10
SOUTH	≈5,280'	TO THE SE CORNER SECTION 16
WEST	≈5,280'	TO THE SW CORNER SECTION 16
NORTH	≈2,640'	TO THE EAST 1/4 CORNER SECTION 17
WEST	≈5,280'	TO THE WEST 1/4 CORNER SECTION 17
WEST	≈5,280'	TO THE WEST 1/4 CORNER SECTION 18
NORTH	≈2,640'	TO THE NW CORNER SECTION 18
NORTH	≈2,640'	TO THE WEST 1/4 SECTION 7
EAST	≈5,280'	TO THE EAST 1/4 CORNER SECTION 7
EAST	≈5,280'	TO THE EAST 1/4 CORNER SECTION 8
EAST	≈2,640'	TO THE NE CORNER OF THE SW 1/4 SECTION 9
N 80° 77' E	≈5,443'	ALONG THE SOUTH R-O-W LINE OF STATE HIGHWAY 123, TO THE EAST LINE OF THE WEST 1/2 OF THE NE 1/4 SEC. 10
SOUTH	≈3,960'	TO THE POINT OF BEGINNING.

— TOWNSHIP 15 SOUTH —

— RANGE 13 EAST —

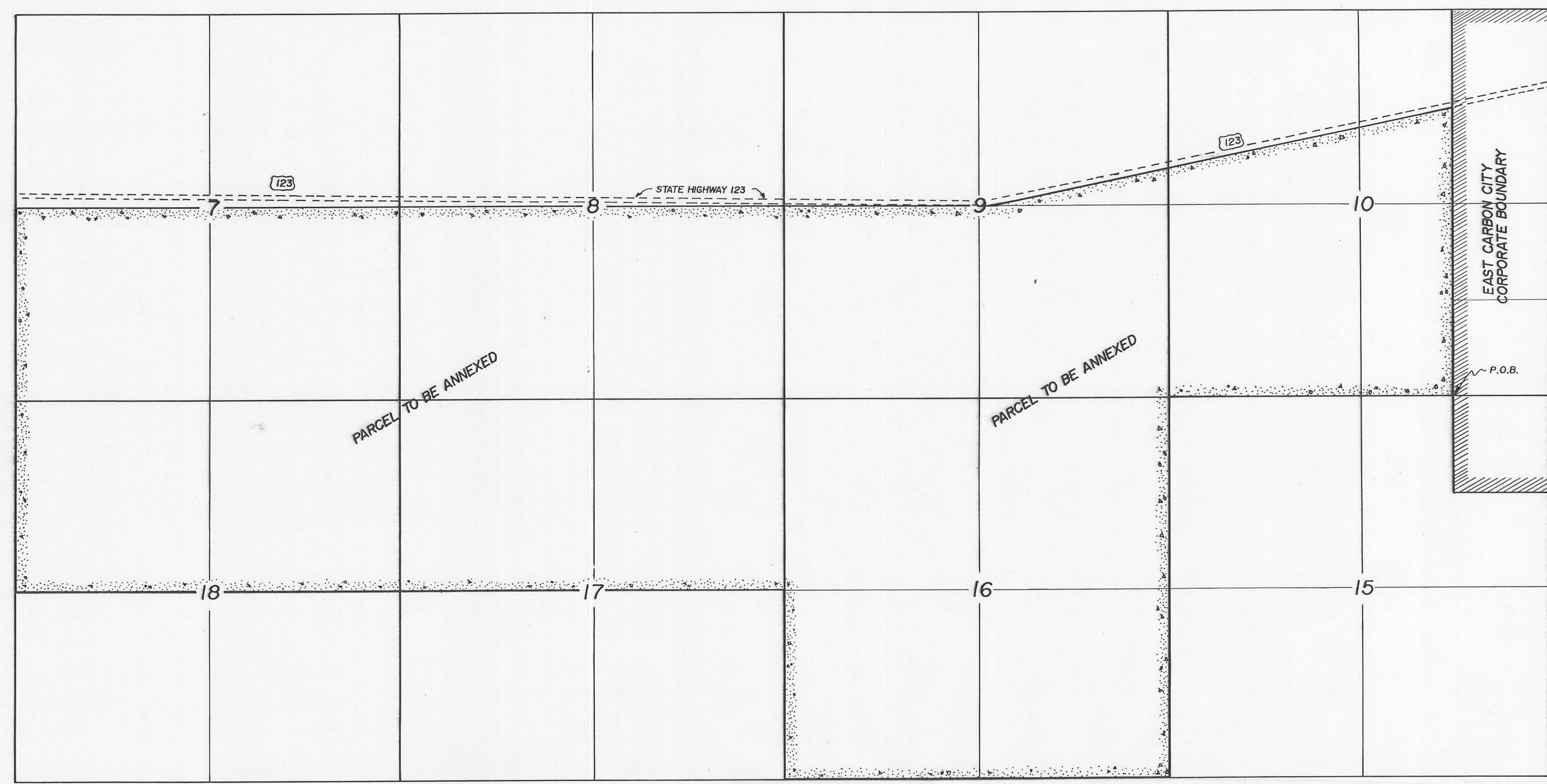

BIG SPRINGS RANCH ANNEXATION

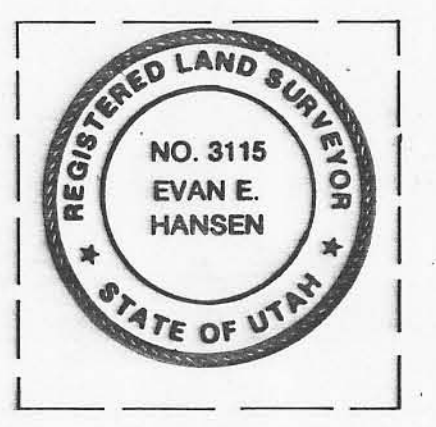
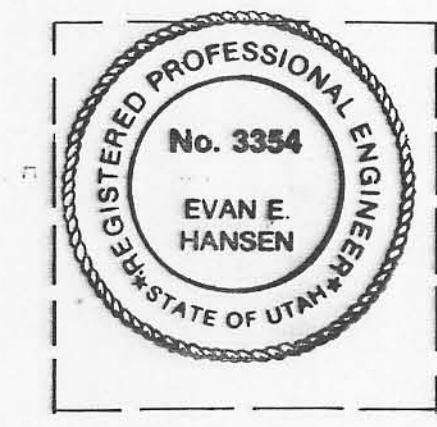

Evan E. Hansen
 EVAN E. HANSEN

JULY 20 1989
 DATE

ACCEPTANCE BY LEGISLATIVE BODY

THIS IS TO CERTIFY THAT WE, EAST CARBON CITY COUNCIL HAVE RECEIVED A PETITION SIGNED BY A MAJORITY OF THE OWNERS OF THE TRACT SHOWN HEREON REQUESTING THAT SAID TRACT BE ANNEXED TO THE CITY OF EAST CARBON AND THAT A COPY OF THE ORDINANCE HAS BEEN PREPARED FOR A FILING HERewith ALL IN ACCORDANCE WITH THE UTAH CODE ANNOTATED (MAY 8, 1979) 10-2-401 THRU 423 AND THAT WE HAVE EXAMINED AND DO HEREBY APPROVE AND ACCEPT THE ANNEXATION OF THE TRACT AS SHOWN AS A PART OF SAID CITY AND THAT SAID TRACT OF LAND IS TO BE KNOWN HEREAFTER AS THE BIG SPRINGS RANCH ANNEXATION.

DATED THIS 25TH DAY OF JULY 1989 A.D.
 CITY OF EAST CARBON A MUNICIPAL CORPORATION.

BY: *James H. Roberts*
 MAYOR
Jana Valdez
 COUNCIL MEMBER
Donald B. M. Grant
 COUNCIL MEMBER